



COMAR MARINE LLC

P.O. Box 1550 • Amelia, Louisiana 70340
25742 Old Hwy 1 • Golden Meadow, Louisiana 70357
(985) 631-2628
sales@comarmarine.com
www.comarmarine.com



140'x 26' CREWBOAT | M/V RENEGADE

MAIN PARTICULARS

LENGTH OVERALL	140.0 ft.	42.67 m
BEAM (HULL)	26.0 ft.	7.92 m
DEPTH	12.0 ft.	3.66 m
DRAFT (LIGHT)	7.0 ft.	2.13 m
DRAFT (MAX.)	9.0 ft.	2.74 m

CONSTRUCTION

HULL	ALUMINUM
SUPERSTRUCTURE	ALUMINUM

PERFORMANCE

SPEED	23 KTS.
FUEL CONSUMPTION	140 GPH

DECK CARGO

BOARDED DECK LENGTH	77 ft.	23.47 m
BOARDED DECK WIDTH	24 ft.	7.32 m
BOARDED DECK AREA	1,848 sq.ft.	171.68 m
DECK CAPACITY	135 LT	137.17 MT

TRANSFER WATER/FUEL

TRANSFERABLE POTABLE WATER	20,700 USG	78.36 m ³
SHIP/TRANSFERABLE FUEL	4,300 USG	16.28 m ³
TRANSFERABLE FUEL	5,600 USG	21.20 m ³

TRANSFER RATES

FUEL	175 GPM	0.80 m ³ /min.
POTABLE WATER	175 GPM	0.80 m ³ /min.

ACCOMMODATIONS

PASSENGERS	67
STATEROOMS	(2) SINGLE, (1) DOUBLE, (1) 4-MAN
BUNKS	(8) TOTAL
HEADS	2
SHOWER	1
GALLEY SEATING	9
AIR CONDITIONING/HEATING	2/1

MACHINERY

TOTAL HORSEPOWER	3,300 HP
MAIN ENGINES	(4) CAT 3412 @ 825 BHP EACH
GEARS	(4) TWIN DISC 5202, RATIO 2.5:1
GENERATORS	(2) GM 371/DELCO 40 KW
FIRE MONITOR	1,000 GPM @ 1800 RPM

ELECTRONICS

VHF	2
SSB	1
RADAR	2
GPS CHART PLOTTER	1
FATHOMETER	1
AIS SYSTEM	1
WEATHER FAX	1
STARLINK	1
SECURITY CAMERA SYSTEM	1
SPOTLIGHTS	2
DECKLIGHTS	2

DOCUMENTATION - CERTIFICATION

YEAR BUILT	1994
BUILDER	BREAUX BAY CRAFT
HULL NUMBER	1651
OFFICIAL #	1021325
TONNAGE - GROSS	90
TONNAGE - NET	61
HOME PORT	MORGAN CITY, LA
FLAG	USA
CLASSIFICATION	USCG CERTIFIED, SUBCHAPTER T
ROUTE	US GOM 200 NM
OTHER	CERTIFIED TO CARRY AVIATION FUEL

SAFETY

INFLATABLE LIFT RAFTS	2
LIFE JACKETS	75
EPIRB	1
RESCUE PLATFORM	1
LIFE RINGS	3

CoMar Marine is a privately owned and operated offshore marine transportation company that has been providing our customers with dependable, well-maintained vessels crewed by well-qualified and capable personnel since 1955.

All information provided herein is believed to be true and accurate at the time of printing and can be used to determine if the vessel is applicable to your needs. The Company takes great care to ensure that the information provided is accurate and up to date. The Company does not warranty the accuracy of data and shall not be held liable for any damages that may incur from the use of the information provided herein. A physical inspection of the subject vessel can be carried out to confirm exact specifications.



COMAR MARINE LLC

P.O. Box 1550 • Amelia, Louisiana 70340
25742 Old Hwy 1 • Golden Meadow, Louisiana 70357
(985) 631-2628
sales@comarmarine.com
www.comarmarine.com



140'x 26' CREWBOAT | M/V RENEGADE

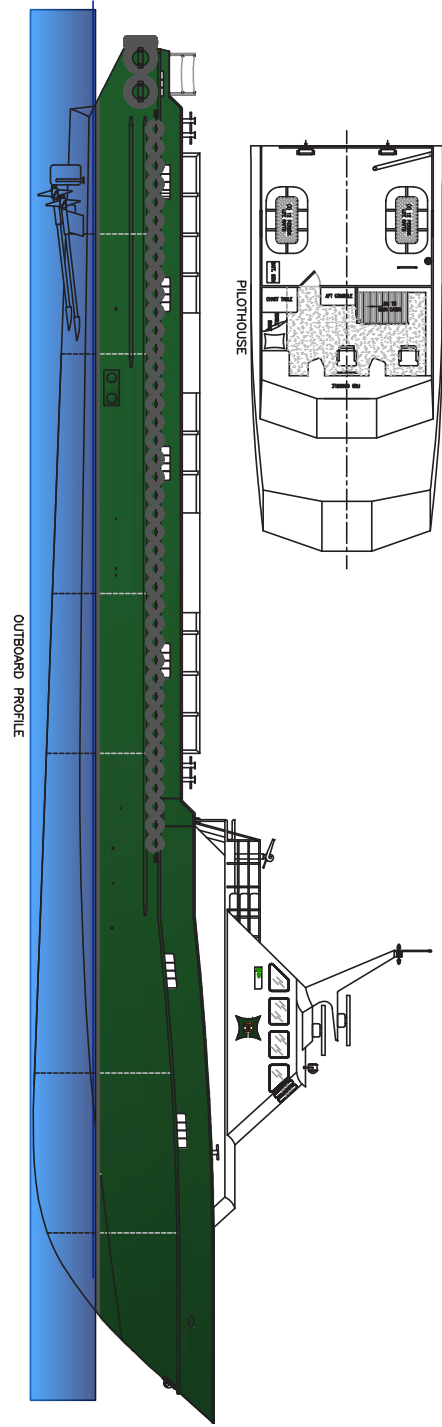
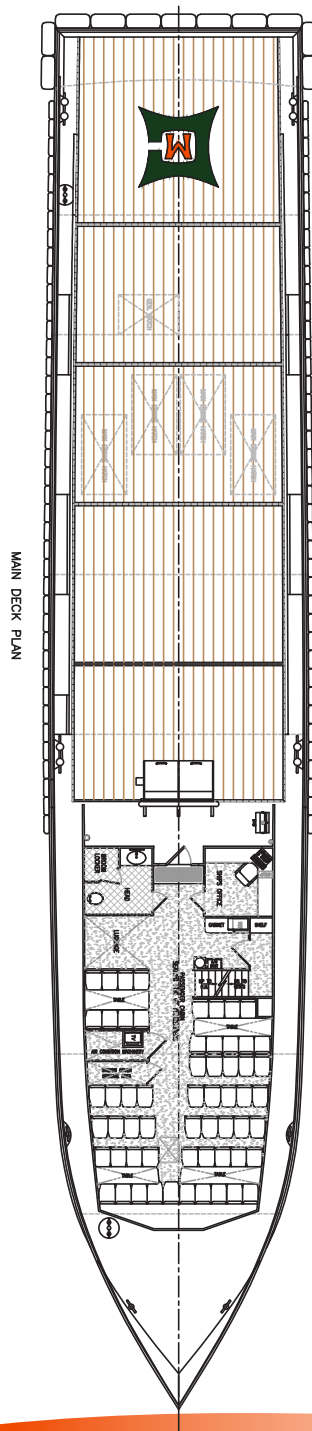
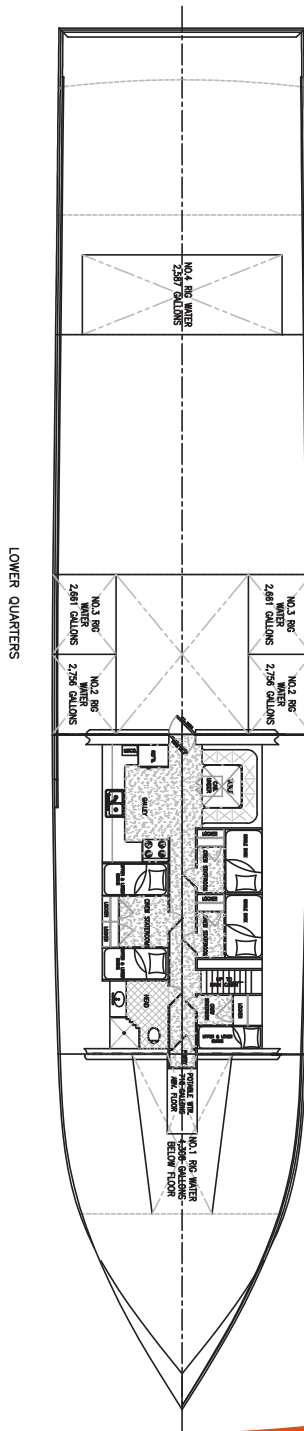

CoMar Marine is a privately owned and operated offshore marine transportation company that has been providing our customers with dependable, well-maintained vessels crewed by well-qualified and capable personnel since 1955.

All information provided herein is believed to be true and accurate at the time of printing and can be used to determine if the vessel is applicable to your needs. The Company takes great care to ensure that the information provided is accurate and up to date. The Company does not warranty the accuracy of data and shall not be held liable for any damages that may incur from the use of the information provided herein. A physical inspection of the subject vessel can be carried out to confirm exact specifications.